



Spare Parts List

V/OGELSANG



WaterUnit WS Cabinet

Machine Type

YSR0000001

Part Number

Table of Contents

Drw-Pos.	ERP-Pos.	Denomination	Quantity	Part	Page
10	10	Pressure Booster Unit Delivery Rate: 8 m³/h	1.000 St	YDC0216	
20	20	Cabinet 1590 mm x 990 mm x 1657 mm	1.000 St	GYC0000016	4
30	30	Raw Base WaterUnit WS	1.000 St	GYO0089	
40	40	Control WaterUnit WS 4 kW 400 V	1.000 St	EPM0000481	13
50	50	Temperature Sensor LP7-PT1000-2L-1.0 Cable lug Ø	2.000 St	SSS0000006	
60	60	Finned Heater 250 W, 230 V	2.000 St	PRO0004	
70	70	Pipeworks WaterUnit WS	1.000 St	IBA0001423	14
80	80	Drip Pan WaterUnit WS	1.000 St	IBA0001424	16
90	90	Pipeworks Suction Unit	1.000 St	IBA0001425	17
100	100	Pipeworks WaterUnit WS	1.000 St	IBA2772	18
110	110	Earthing Bolt Screw Set M 16	2.000 St	IBA3974	20
120	120	Fixing Sheet 3 mm 1.0976	1.000 St	TFL0002460	
130	130	Fixing Sheet 3 mm 1.0976	1.000 St	TFL0002461	
140	140	Anchor bolt FAZ II Plus Ø 10 mm x 50 mm, M 10	4.000 St	NBO0000099	
150	150	Hexagon Nut M 12 , DIN 934	6.000 St	NMS.004	
160	160	Blind Rivet A Ø 3 mm x 5 mm	4.000 St	NNI.002	
170	170	Blind Rivet Nut Small Countersunk Head, M 5	4.000 St	NNM0000002	
180	180	Hexagon Head Bolt M 12 x 45 mm DIN 933	4.000 St	NSK.031	
190	190	Hexagon Head Bolt M 12 x 30 mm DIN 933	2.000 St	NSK.028	
200	200	Hexagon Head Bolt M 5 x 40 mm DIN 933	4.000 St	NSK0057	
210	210	Washer A Ø 13 mm x Ø 24 mm x 2,5 mm	12.000 St	NUS.005	
220	220	Washer A Ø 5,3 mm x Ø 10 mm x 1 mm	4.000 St	NUS.120	
230	230	Cap Trail TS 35 35 mm x 7,5 mm x 75 mm	2.000 St	EPM0727	
240	240	Name Plate 70 x 60 x 0,8 mm General	1.000 St	VAU0120	
250	250	Sticker Parts Kit VacUnit SP	1.000 St	VAU0409	21
260	260	Cellular Rubber Sealing EPDM 4 mm	0.780 m	TFD.021	
270	270	Hexagon Nut M 10 , DIN 934	4.000 St	NMS.003	
280	280	Hexagon Head Bolt M 10 x 140 mm DIN 931	4.000 St	NSK.038	
290	290	Washer A Ø 10,5 mm x Ø 30 mm x 2,5 mm	8.000 St	NUS.026	

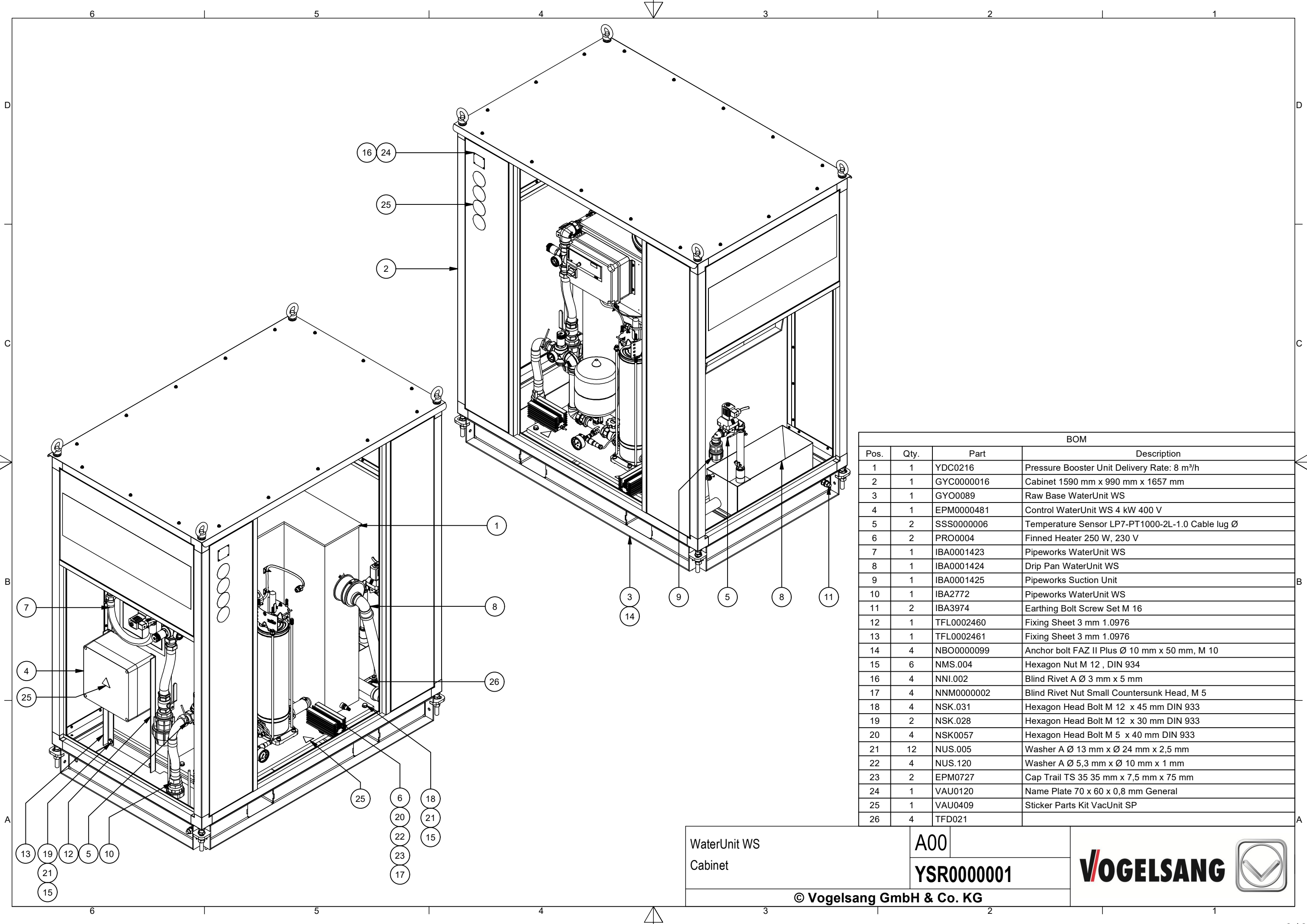

BOM			
Pos.	Qty.	Part	Description
1	1	YDC0216	Pressure Booster Unit Delivery Rate: 8 m³/h
2	1	GYC0000016	Cabinet 1590 mm x 990 mm x 1657 mm
3	1	GYO0089	Raw Base WaterUnit WS
4	1	EPM0000481	Control WaterUnit WS 4 kW 400 V
5	2	SSS0000006	Temperature Sensor LP7-PT1000-2L-1.0 Cable lug Ø
6	2	PRO0004	Finned Heater 250 W, 230 V
7	1	IBA0001423	Pipeworks WaterUnit WS
8	1	IBA0001424	Drip Pan WaterUnit WS
9	1	IBA0001425	Pipeworks Suction Unit
10	1	IBA2772	Pipeworks WaterUnit WS
11	2	IBA3974	Earthing Bolt Screw Set M 16
12	1	TFL0002460	Fixing Sheet 3 mm 1.0976
13	1	TFL0002461	Fixing Sheet 3 mm 1.0976
14	4	NBO0000099	Anchor bolt FAZ II Plus Ø 10 mm x 50 mm, M 10
15	6	NMS.004	Hexagon Nut M 12 , DIN 934
16	4	NNI.002	Blind Rivet A Ø 3 mm x 5 mm
17	4	NNM0000002	Blind Rivet Nut Small Countersunk Head, M 5
18	4	NSK.031	Hexagon Head Bolt M 12 x 45 mm DIN 933
19	2	NSK.028	Hexagon Head Bolt M 12 x 30 mm DIN 933
20	4	NSK0057	Hexagon Head Bolt M 5 x 40 mm DIN 933
21	12	NUS.005	Washer A Ø 13 mm x Ø 24 mm x 2,5 mm
22	4	NUS.120	Washer A Ø 5,3 mm x Ø 10 mm x 1 mm
23	2	EPM0727	Cap Trail TS 35 35 mm x 7,5 mm x 75 mm
24	1	VAU0120	Name Plate 70 x 60 x 0,8 mm General
25	1	VAU0409	Sticker Parts Kit VacUnit SP
26	4	TFD021	

WaterUnit WS
Cabinet

A00

YSR0000001

© Vogelsang GmbH & Co. KG

VOGELSANG

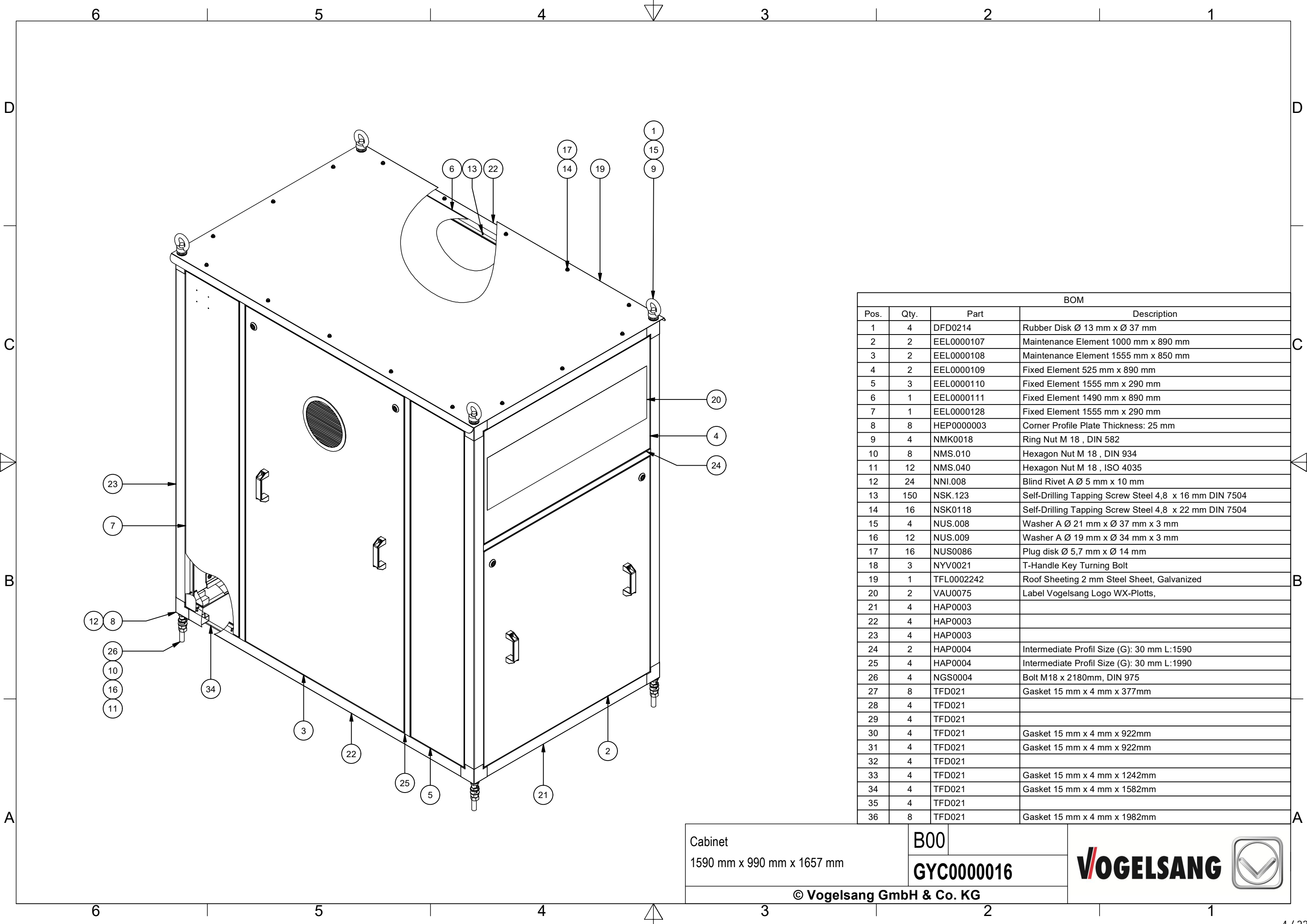

Cabinet
1590 mm x 990 mm x 1657 mm

B00

GYC0000016

© Vogelsang GmbH & Co. KG

VOGELSANG

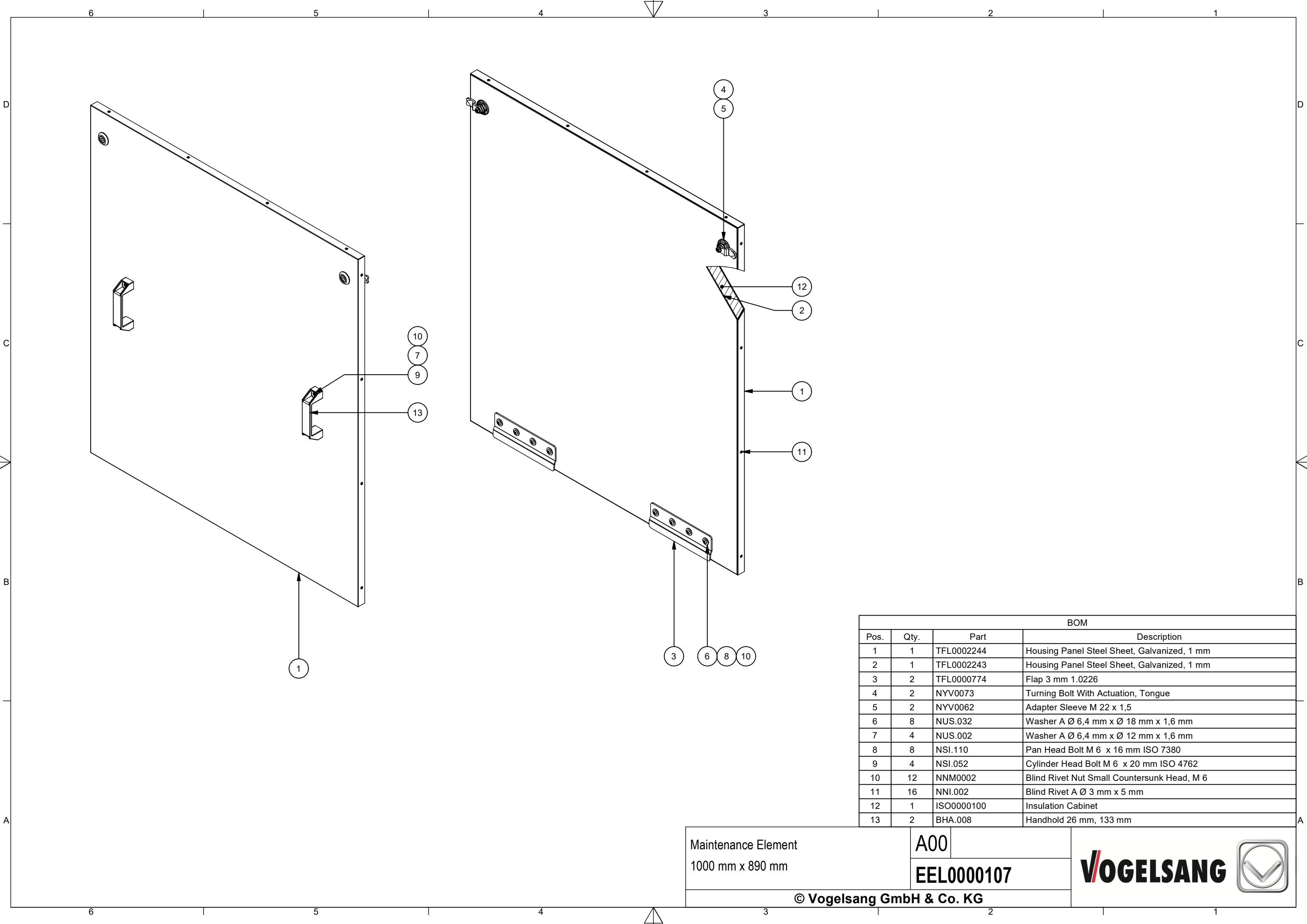

BOM			
Pos.	Qty.	Part	Description
1	1	TFL0002244	Housing Panel Steel Sheet, Galvanized, 1 mm
2	1	TFL0002243	Housing Panel Steel Sheet, Galvanized, 1 mm
3	2	TFL0000774	Flap 3 mm 1.0226
4	2	NYV0073	Turning Bolt With Actuation, Tongue
5	2	NYV0062	Adapter Sleeve M 22 x 1,5
6	8	NUS.032	Washer A Ø 6,4 mm x Ø 18 mm x 1,6 mm
7	4	NUS.002	Washer A Ø 6,4 mm x Ø 12 mm x 1,6 mm
8	8	NSI.110	Pan Head Bolt M 6 x 16 mm ISO 7380
9	4	NSI.052	Cylinder Head Bolt M 6 x 20 mm ISO 4762
10	12	NNM0002	Blind Rivet Nut Small Countersunk Head, M 6
11	16	NNI.002	Blind Rivet A Ø 3 mm x 5 mm
12	1	ISO0000100	Insulation Cabinet
13	2	BHA.008	Handhold 26 mm, 133 mm

Maintenance Element 1000 mm x 890 mm	A00	
	EEL0000107	
	© Vogelsang GmbH & Co. KG	

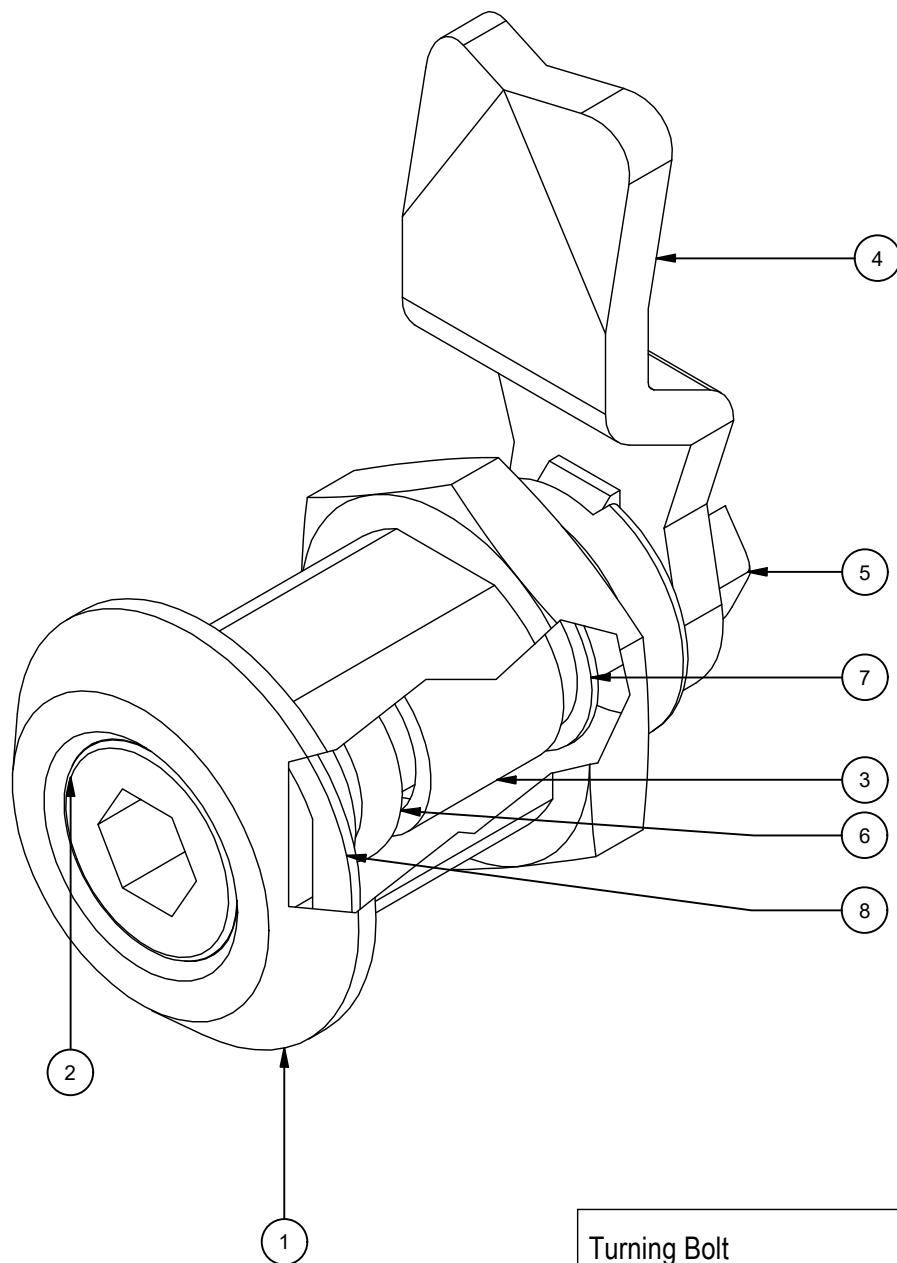

BOM			
Pos.	Qty.	Part	Description
1	1	NYV0000008	Lock Housing Locking Operation
2	1	NYV0072	Locking Actuator Hexagon Socket
3	1	NYV0000009	Actuating Adapter Zinc Diecasting
4	1	NYV0071	Tongue Cam Crank: Top
5	1	NSK0370	Hexagon Head Bolt M 6 x 25 mm ≈ DIN 6921
6	1	DOR0629	O-Ring Ø 9,25 mm x 3 mm
7	1	NUS0257	Washer Ø 10,5 mm x Ø 15,5 mm x 0,6 mm
8	1	DFD0563	Flat Gasket Turning bolt

Turning Bolt
With Actuation, Tongue

D00

NYV0073

© Vogelsang GmbH & Co. KG

VOGELSANG



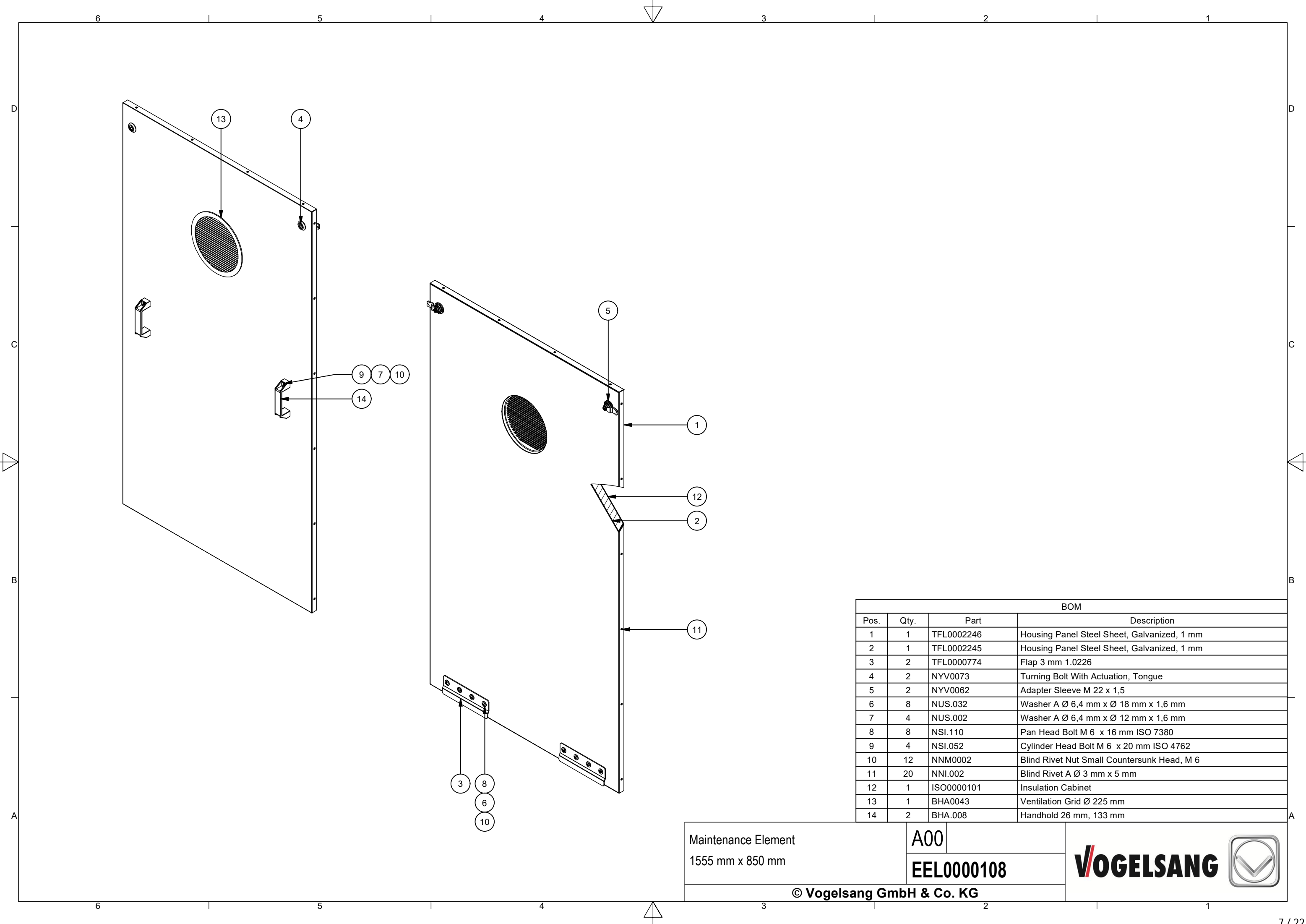

BOM			
Pos.	Qty.	Part	Description
1	1	TFL0002246	Housing Panel Steel Sheet, Galvanized, 1 mm
2	1	TFL0002245	Housing Panel Steel Sheet, Galvanized, 1 mm
3	2	TFL0000774	Flap 3 mm 1.0226
4	2	NYV0073	Turning Bolt With Actuation, Tongue
5	2	NYV0062	Adapter Sleeve M 22 x 1,5
6	8	NUS.032	Washer A Ø 6,4 mm x Ø 18 mm x 1,6 mm
7	4	NUS.002	Washer A Ø 6,4 mm x Ø 12 mm x 1,6 mm
8	8	NSI.110	Pan Head Bolt M 6 x 16 mm ISO 7380
9	4	NSI.052	Cylinder Head Bolt M 6 x 20 mm ISO 4762
10	12	NNM0002	Blind Rivet Nut Small Countersunk Head, M 6
11	20	NNI.002	Blind Rivet A Ø 3 mm x 5 mm
12	1	ISO0000101	Insulation Cabinet
13	1	BHA0043	Ventilation Grid Ø 225 mm
14	2	BHA.008	Handhold 26 mm, 133 mm

Maintenance Element
1555 mm x 850 mm

A00

EEL0000108

© Vogelsang GmbH & Co. KG

VOGELSANG

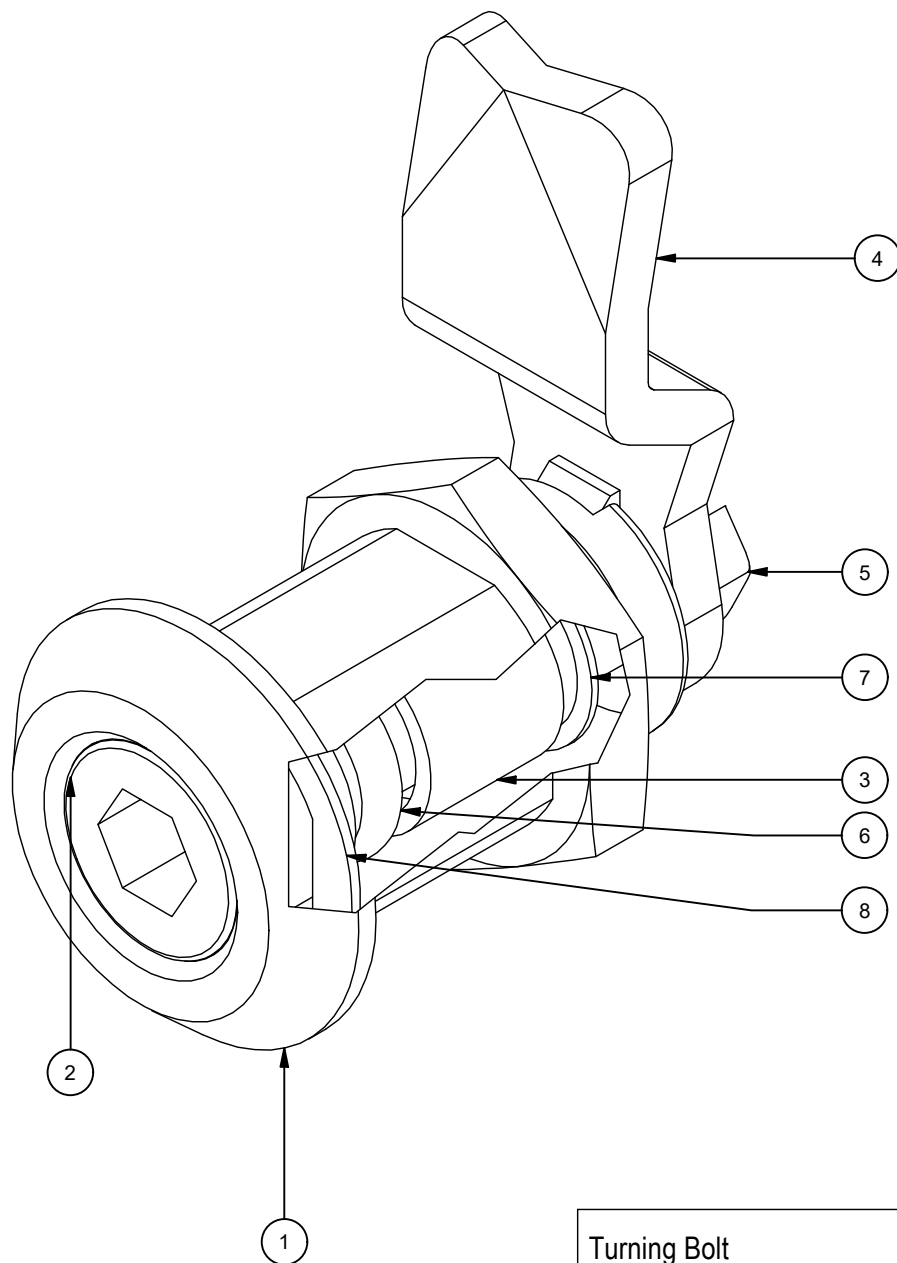

BOM			
Pos.	Qty.	Part	Description
1	1	NYV0000008	Lock Housing Locking Operation
2	1	NYV0072	Locking Actuator Hexagon Socket
3	1	NYV0000009	Actuating Adapter Zinc Diecasting
4	1	NYV0071	Tongue Cam Crank: Top
5	1	NSK0370	Hexagon Head Bolt M 6 x 25 mm ≈ DIN 6921
6	1	DOR0629	O-Ring Ø 9,25 mm x 3 mm
7	1	NUS0257	Washer Ø 10,5 mm x Ø 15,5 mm x 0,6 mm
8	1	DFD0563	Flat Gasket Turning bolt

Turning Bolt
With Actuation, Tongue

D00

NYV0073

© Vogelsang GmbH & Co. KG

VOGELSANG



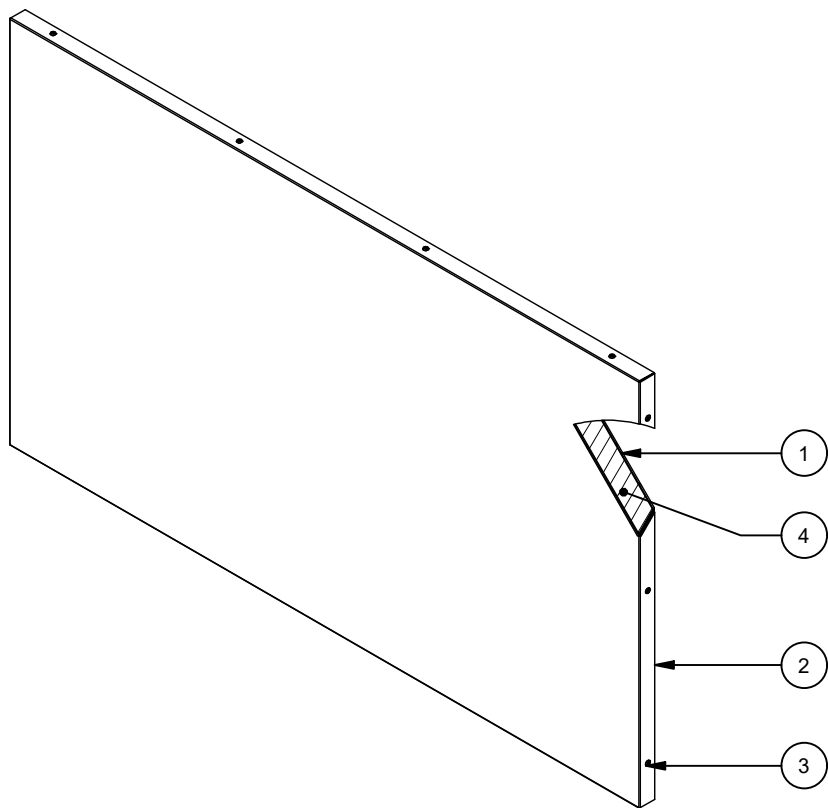

BOM			
Pos.	Qty.	Part	Description
1	1	TFL0002248	Housing Panel Steel Sheet, Galvanized, 1 mm
2	1	TFL0002247	Housing Panel Steel Sheet, Galvanized, 1 mm
3	14	NNI0002	Blind Rivet A Ø 3,2 mm x 8 mm
4	1	ISO0000102	Insulation Cabinet

Fixed Element
525 mm x 890 mm

A00

EEL0000109

© Vogelsang GmbH & Co. KG

VOGELSANG



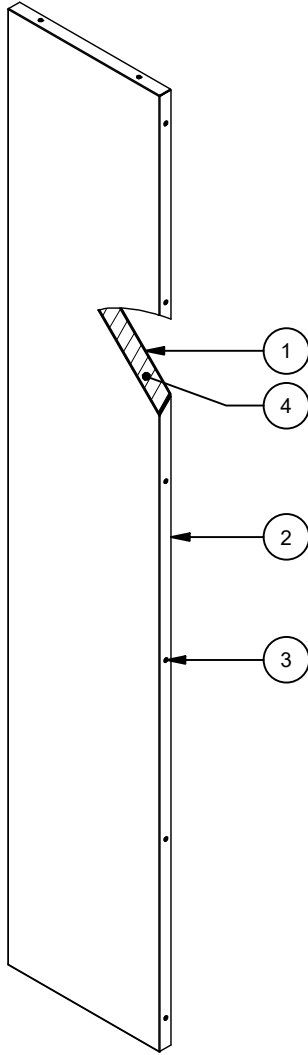

BOM			
Pos.	Qty.	Part	Description
1	1	TFL0002250	Housing Panel Steel Sheet, Galvanized, 1 mm
2	1	TFL0002249	Housing Panel Steel Sheet, Galvanized, 1 mm
3	16	NNI0002	Blind Rivet A Ø 3,2 mm x 8 mm
4	1	ISO0000103	Insulation Cabinet

Fixed Element
1555 mm x 290 mm

A00

EEL0000110

© Vogelsang GmbH & Co. KG

VOGELSANG



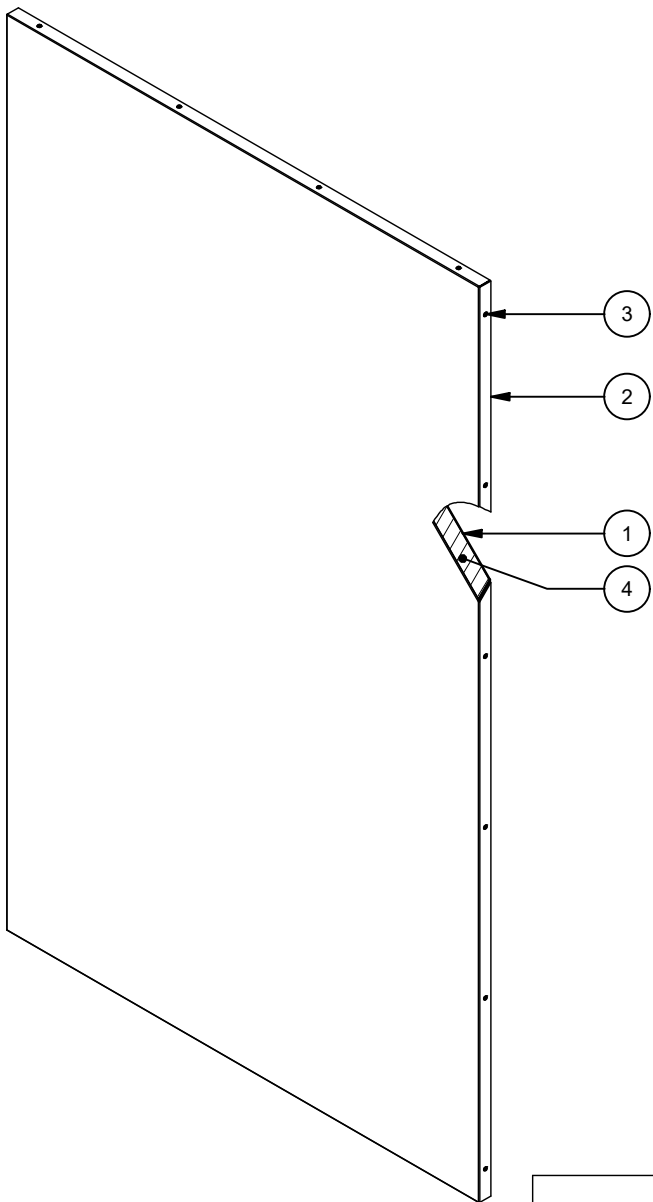

BOM			
Pos.	Qty.	Part	Description
1	1	TFL0002252	Housing Panel Steel Sheet, Galvanized, 1 mm
2	1	TFL0002251	Housing Panel Steel Sheet, Galvanized, 1 mm
3	20	NNI0002	Blind Rivet A Ø 3,2 mm x 8 mm
4	1	ISO0000104	Insulation Cabinet

Fixed Element
1490 mm x 890 mm

A00

EEL0000111

© Vogelsang GmbH & Co. KG

VOGELSANG



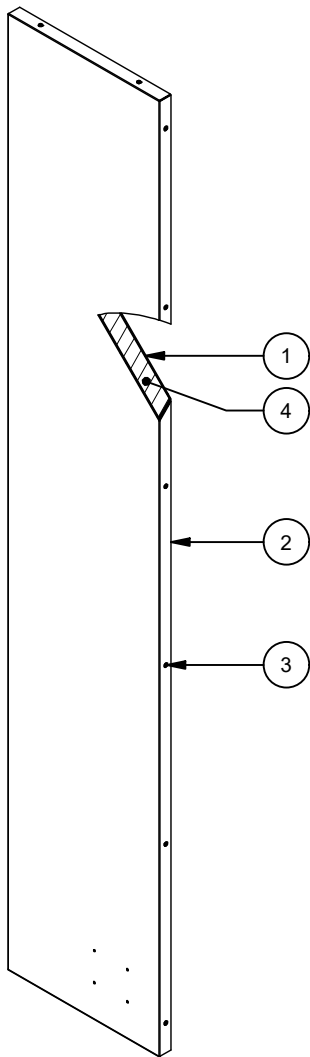

BOM			
Pos.	Qty.	Part	Description
1	1	TFL0002250	Housing Panel Steel Sheet, Galvanized, 1 mm
2	1	TFL0002430	Housing Panel Steel Sheet, Galvanized, 1 mm
3	16	NNI0002	Blind Rivet A Ø 3,2 mm x 8 mm
4	1	ISO0000103	Insulation Cabinet

Fixed Element
1555 mm x 290 mm

A00

EEL0000128

© Vogelsang GmbH & Co. KG

VOGELSANG



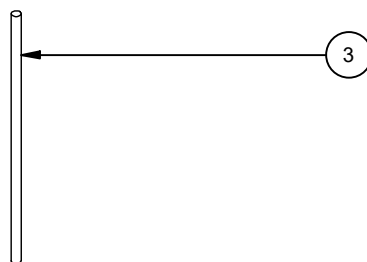
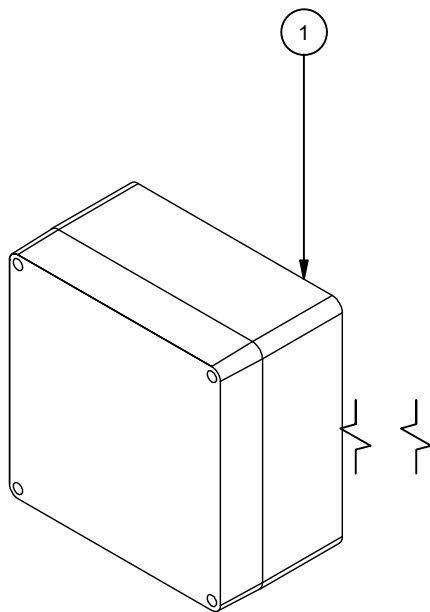

BOM			
Pos.	Qty.	Part	Description
1	1	EPM0000483	Control Cabinet 300 mm x 300 mm x 170 mm
2	1	SWA0011	Float Switch Float Diameter Ø 25 mm
3	2	EPM.084	Trace Heating 10 W/m, 230 V

Control WaterUnit WS

4 kW 400 V

A00

EPM0000481

© Vogelsang GmbH & Co. KG

Vogelsang



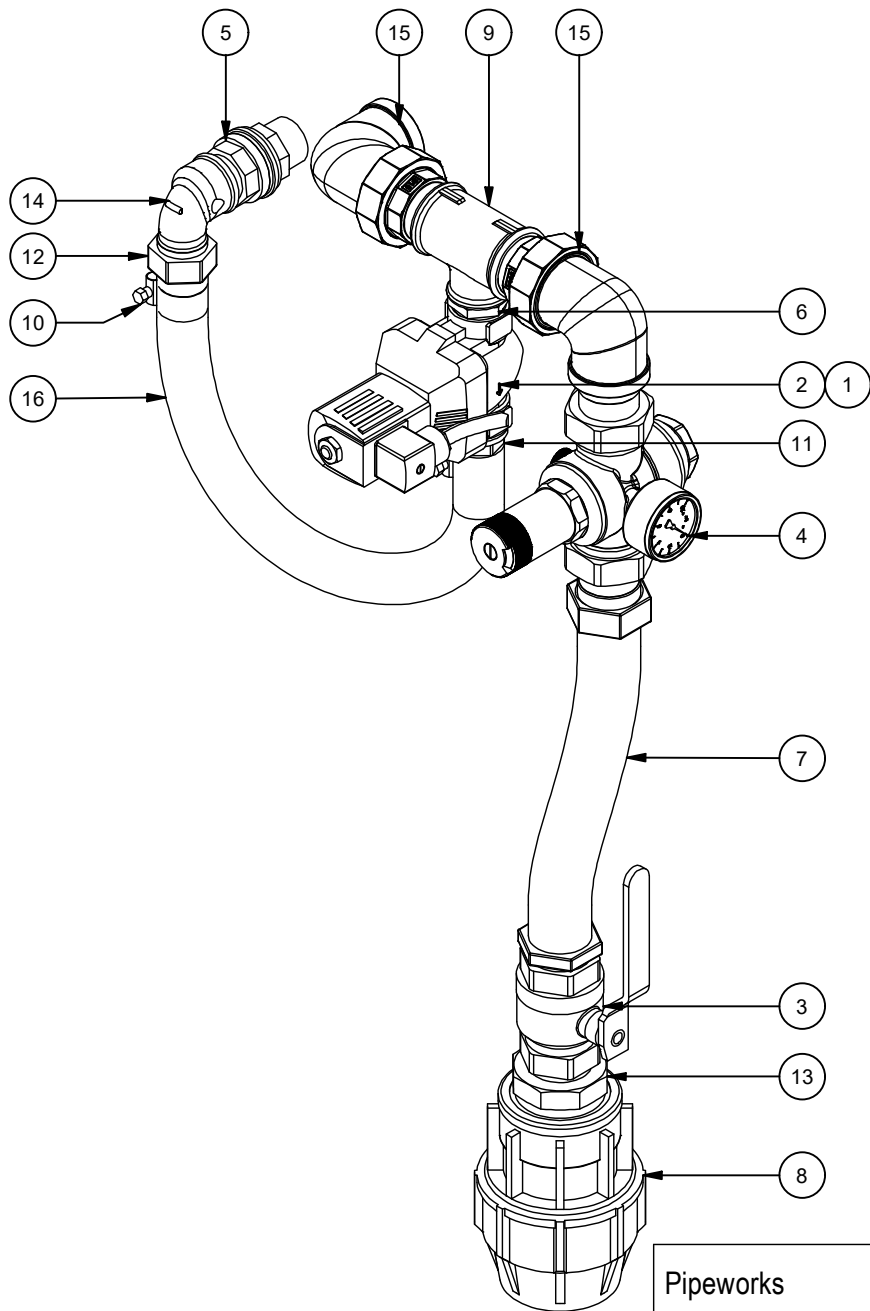

BOM			
Pos.	Qty.	Part	Description
1	1	AHV0165	Appliance Outlet Magnetventil
2	1	EPM.041	2/Two-Way-Solenoid Valve Forced Control, 230 V / AC
3	1	GHN.062	2-Way Ball Valve 1 1/4 inch, IG - IG, Stainless Steel
4	1	NDV0048	Pressure Reducer MT R 1 1/4 inch
5	1	HPB0183	Lead-Through 1 inch - 1 inch
6	1	HRS.500.K	Double Pipe Nipple 1 inch x 35 mm,
7	1	HSC0118	Armoured Hose DN 32, 1 1/4 inch MT - FT
8	1	NGE.517	Clamp Connection Ø 63 mm - 2 inch
9	1	NGE0322	T-Fitting 90° 1 1/4 inch / 1 inch / 1 1/4 inch FT, Three
10	2	NSS0069	Clamping Jaws Maximum Clamping Range: 35 mm
11	1	NVE.014	Hose Tail MT 1 inch x Ø 25 mm
12	1	NVE.098	Hose Tail FT 1 inch x Ø 25 mm
13	1	NVE0118	Double Nipple, Reduced 2 inch MT - 1 1/4 inch MT
14	1	NWE.207	Angle 90° 1 inch FT - 1 inch MT
15	2	NWE0045	Elbow Coupling FT 1 1/4 inch - MT 1 1/4 inch
16	1	HSC0203	

Pipeworks
WaterUnit WS

A00

IBA0001423

© Vogelsang GmbH & Co. KG

VOGELSANG



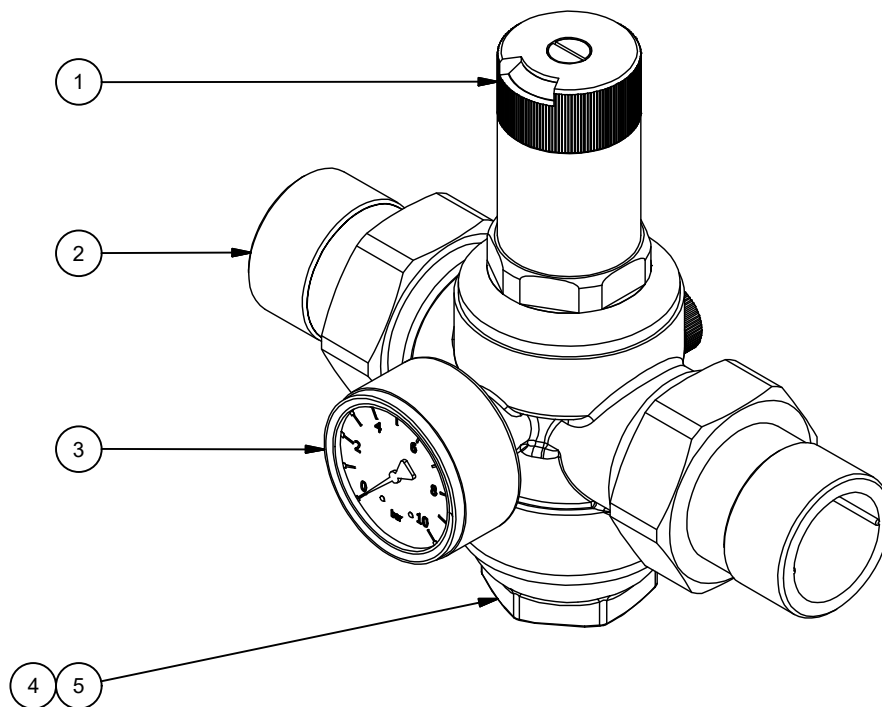

BOM			
Pos.	Qty.	Part	Description
1	1	NDV0047	Pressure Reducer MT R 1 inch
2	2	NVE0233	Reducer 1 1/2 inch FT - 1 1/4 inch MT
3	1	SMD0081	Pressure Gauge 0 - 10 bar
4	1	TXT2988	Ersatzsieb für Druckminderer D06F 1 und 1 1/4
5	1	TXT2989	

Pressure Reducer
MT R 1 1/4 inch

B

NDV0048

© Vogelsang GmbH & Co. KG

VOGELSANG



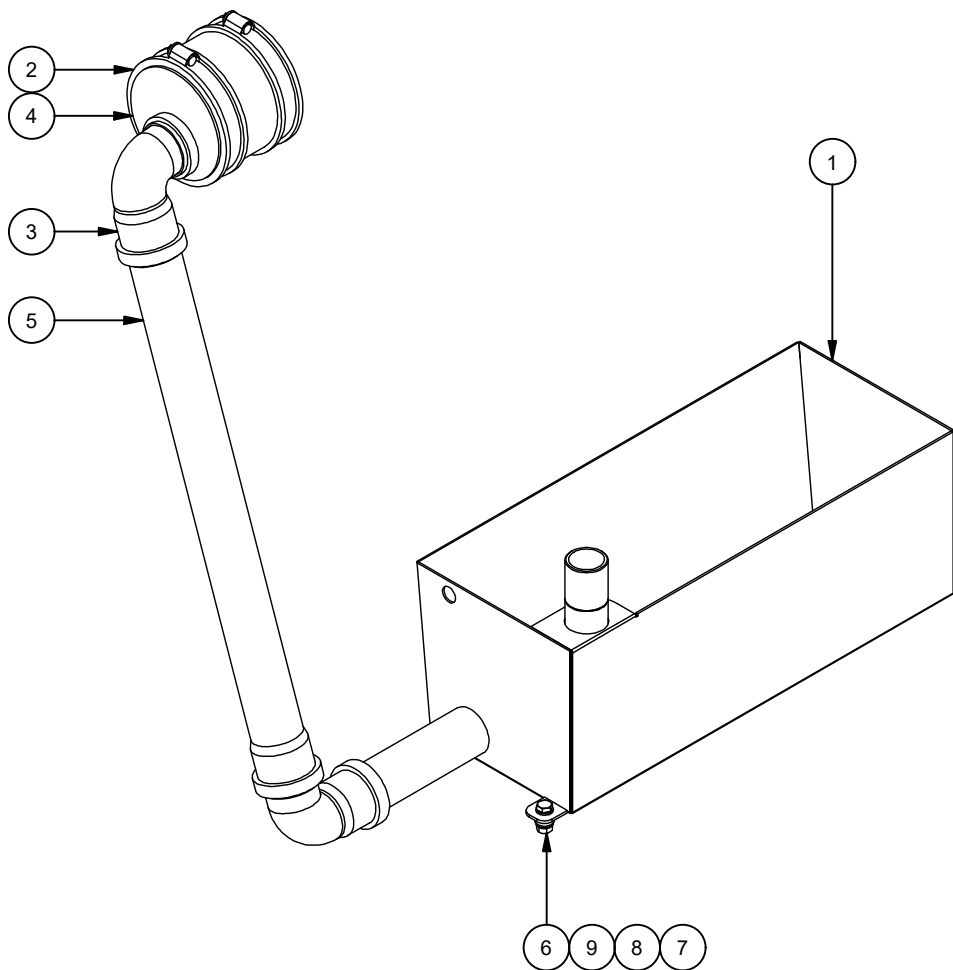

BOM			
Pos.	Qty.	Part	Description
1	1	IBS7612	Catch Tank 1.4571
2	1	NKU0039	Drainage Coupling Crassus Typ 1
3	2	HPB.041	Plastic Elbow Ø 50 mm, 87° PP Connecting Sleeve-Connecting
4	1	HPZ0034	Reducer Ø 110 mm x Ø 50 mm PP, Connecting Piece - Plug-In
5	1	HPR.023.T1	Sewer Pipe Ø 50 mm x 2,0 mm 750 mm
6	2	NSK.019.EE	Hexagon Head Bolt M 8 x 25 mm DIN 933
7	2	NMS.002.E	Hexagon Nut M 8 , DIN 934
8	4	NUS.101	Washer Ø 8,4 mm x Ø 16 mm x 1,6 mm
9	4	NUS.003.E	Washer A Ø 8,4 mm x Ø 16 mm x 1,6 mm

Drip Pan
WaterUnit WS

A00

IBA0001424

© Vogelsang GmbH & Co. KG

VOGELSANG



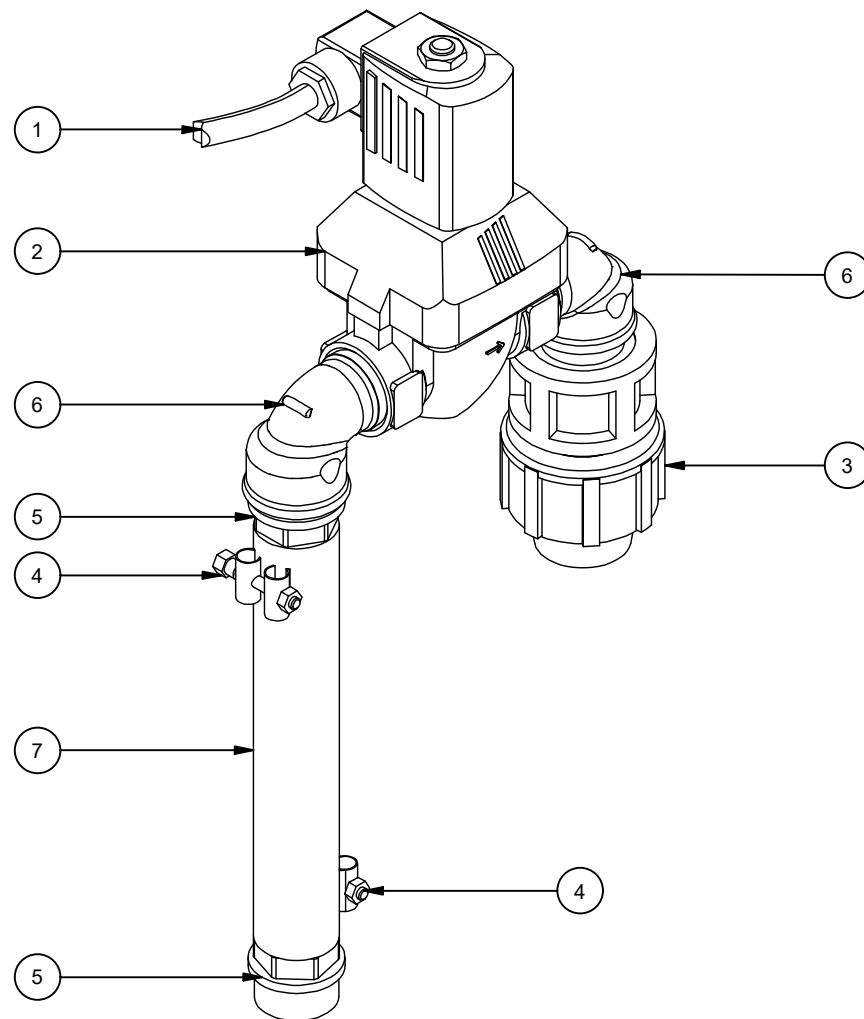

BOM			
Pos.	Qty.	Part	Description
1	1	AHV0165	Appliance Outlet Magnetventil
2	1	EPM.041	2/Two-Way-Solenoid Valve Forced Control, 230 V / AC
3	1	HPB0203	Clamp Connection Ø 32 mm - 1 inch
4	2	NSS0069	Clamping Jaws Maximum Clamping Range: 35 mm
5	2	NVE.014	Hose Tail MT 1 inch x Ø 25 mm
6	2	NWE.207	Angle 90° 1 inch FT - 1 inch MT
7	1	HSC0203	

Pipeworks
Suction Unit

A00

IBA0001425

© Vogelsang GmbH & Co. KG

VOGELSANG



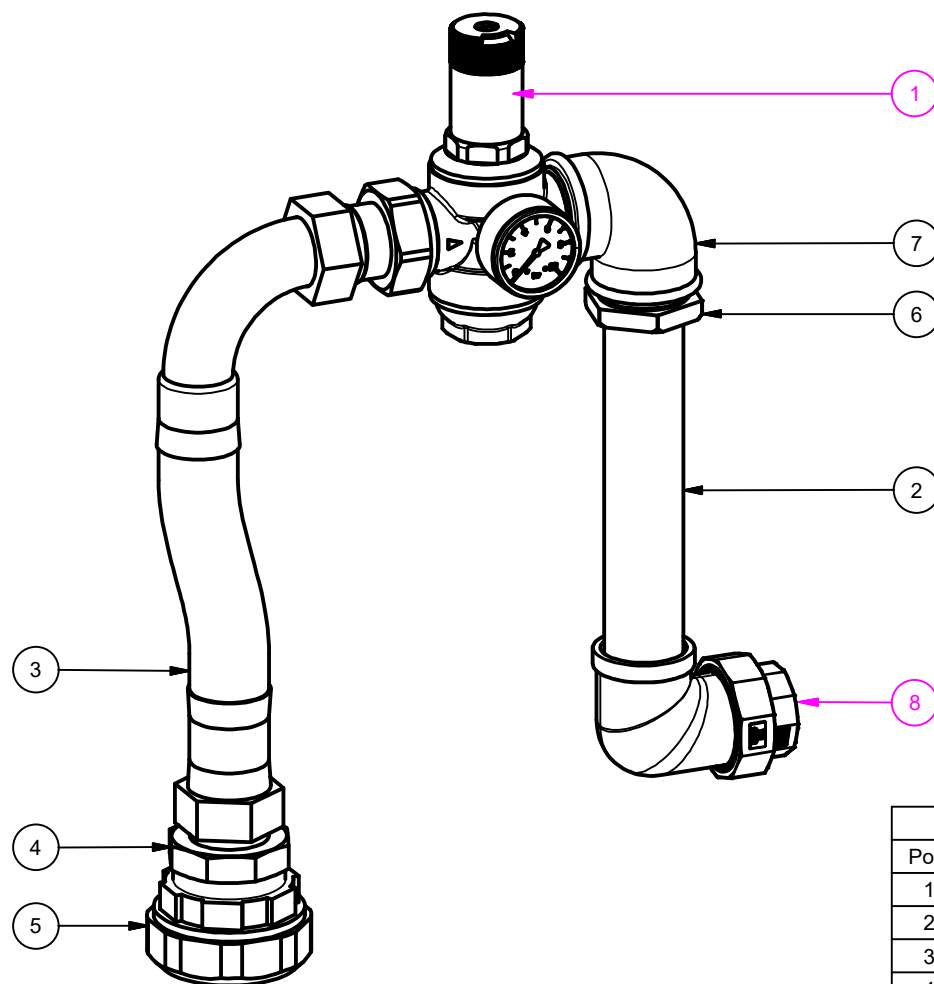

Stückliste			
Pos.	Menge	Teil	Bezeichnung
1	1	NDV0048	Druckminderer AG R 1 1/4 inch
2	1	HRS0442	Rohrdoppelnippel 1 1/4 inch x 230 mm,
3	1	HSC0164	Panzerschlauch DN 32, 1 1/4 inch IG - IG 90°
4	1	NVE0118	Doppelnippel reduziert 2 inch AG - 1 1/4 inch AG
5	1	NVE.064	Anschlussstück Ø 63 mm x 5,8 mm
6	1	NVE0136	Reduzierstück 1 1/2 inch AG - 1 1/4 inch IG
7	1	NWE0038	Winkel 90° 1 1/2 inch IG - 1 1/2 inch IG
8	1	NWE0039	Winkelverschraubung IG 1 1/4 inch - IG 1 1/4 inch

Verrohrung
WaterUnit WS

C

IBA2772

© Vogelsang GmbH & Co. KG

Vogelsang



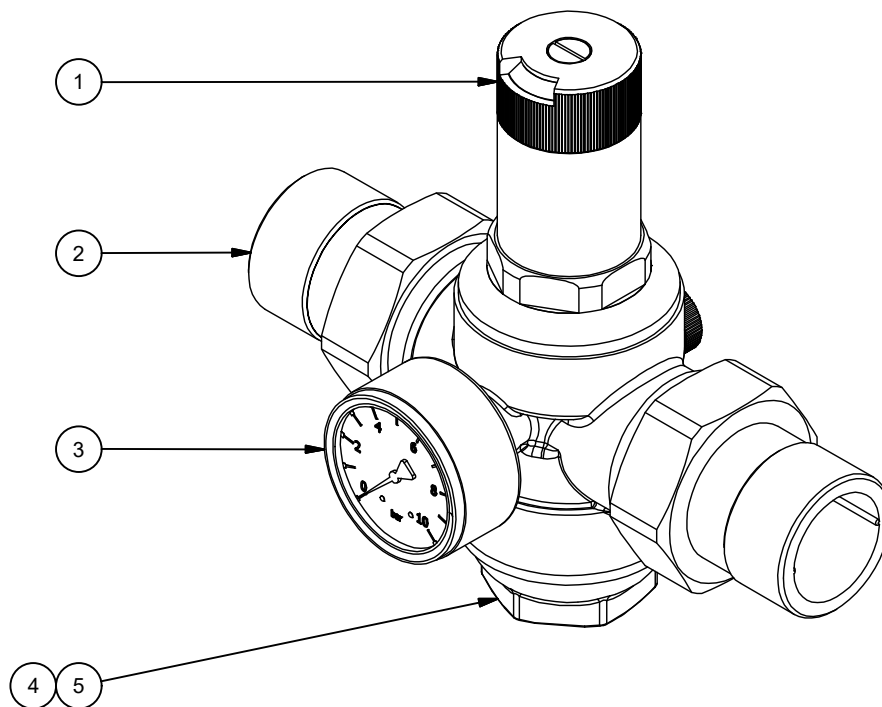

BOM			
Pos.	Qty.	Part	Description
1	1	NDV0047	Pressure Reducer MT R 1 inch
2	2	NVE0233	Reducer 1 1/2 inch FT - 1 1/4 inch MT
3	1	SMD0081	Pressure Gauge 0 - 10 bar
4	1	TXT2988	Ersatzsieb für Druckminderer D06F 1 und 1 1/4
5	1	TXT2989	

Pressure Reducer
MT R 1 1/4 inch

B

NDV0048

© Vogelsang GmbH & Co. KG

VOGELSANG



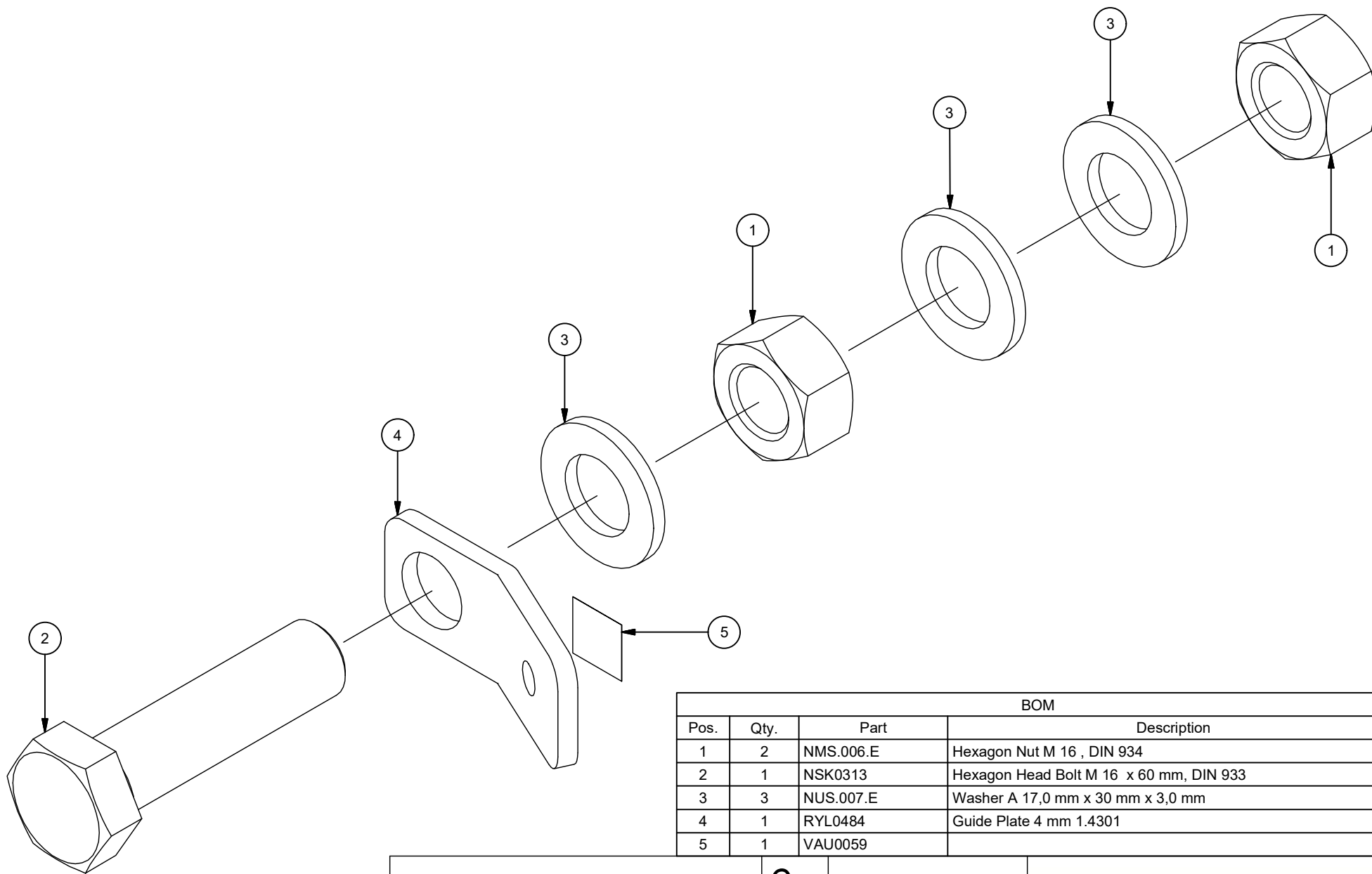

BOM			
Pos.	Qty.	Part	Description
1	2	NMS.006.E	Hexagon Nut M 16 , DIN 934
2	1	NSK0313	Hexagon Head Bolt M 16 x 60 mm, DIN 933
3	3	NUS.007.E	Washer A 17,0 mm x 30 mm x 3,0 mm
4	1	RYL0484	Guide Plate 4 mm 1.4301
5	1	VAU0059	

Earthing Bolt
Screw Set M 16

C

IBA3974

© Vogelsang GmbH & Co. KG

VOGELSANG



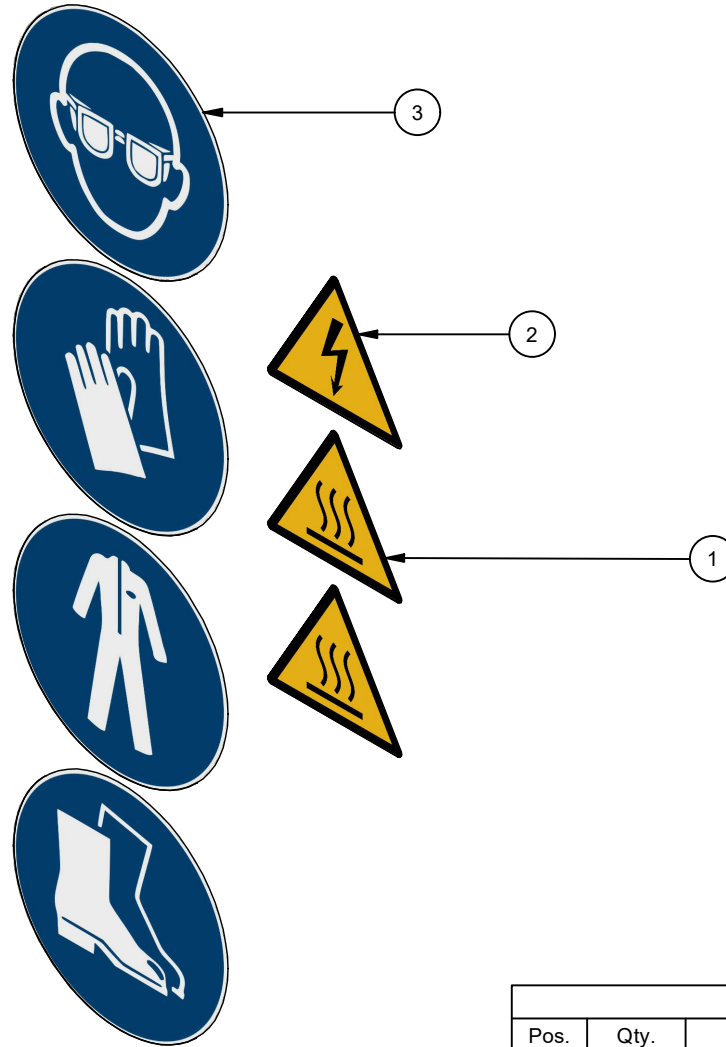

BOM			
Pos.	Qty.	Part	Description
1	2	VAU0121	Label Hot Surface Yellow Yellow, Font Black,
2	1	VAU0216	Label Caution: High Voltage! Gelb/Schwarz -40 °C - +100 °C,
3	1	VAU0262	Label Attention protective clothes Blau/Weiß Aufkleber

Sticker Parts Kit
VacUnit SP

B

VAU0409

© Vogelsang GmbH & Co. KG

VOGELSANG



**Vogelsang GmbH & Co. KG**

Holthöge 10-14, 49632 Essen (Oldenburg), GERMANY

Phone: +49 (0) 5434 83 83 83
+49 (0) 5434 83 99 99

Fax: +49 (0) 5434 83 10

service@vogelsang.infowww.vogelsang.info**Vogelsang Lutherstadt Eisleben**

Gewerbegebiet Rothenschirmbach Nr. 8, 06295 Lutherstadt Eisleben, GERMANY

Phone: +49 (0) 34776 91 92 14

Fax: +49 (0) 34776 91 92 60



Subject to change without notice. Schematic drawings without claim to completeness.